

CITY LIVING

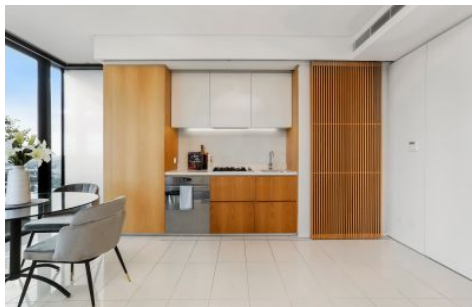

2411/3 Carlton Street Chippendale NSW

1 1 1

Enjoying a prized elevated position in the exclusive 'One Central Park', this light filled apartment boasts spectacular district views while delivering an idyllic lifestyle haven of space, contemporary comfort and ease of living.

View : <https://www.cityliving.com.au/sale/nsw/sydney-city/chippendale/residential/apartment/7422379>

KEY FEATURES

The apartment - Wonderfully spacious and bathed in natural light, it features a clever open plan design with a sleek stone gas kitchen, while zoned living and dining areas open to a sun bathed deck overlooking the complex gardens and beyond.

The building - Located in the acclaimed 'One Central Park', residents enjoy access to resort-style facilities including a heated outdoor pool, spa and a professional gym, while there is a 24-hour concierge service and on-site security.



Tasman Fallshaw
02 8248 9104

<https://www.cityliving.com.au>

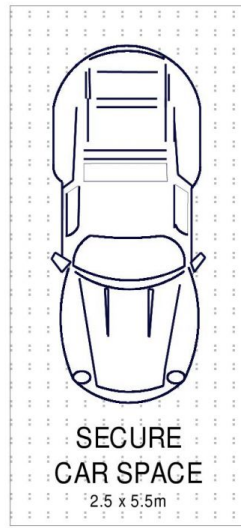

STORE
1m²

BASEMENT

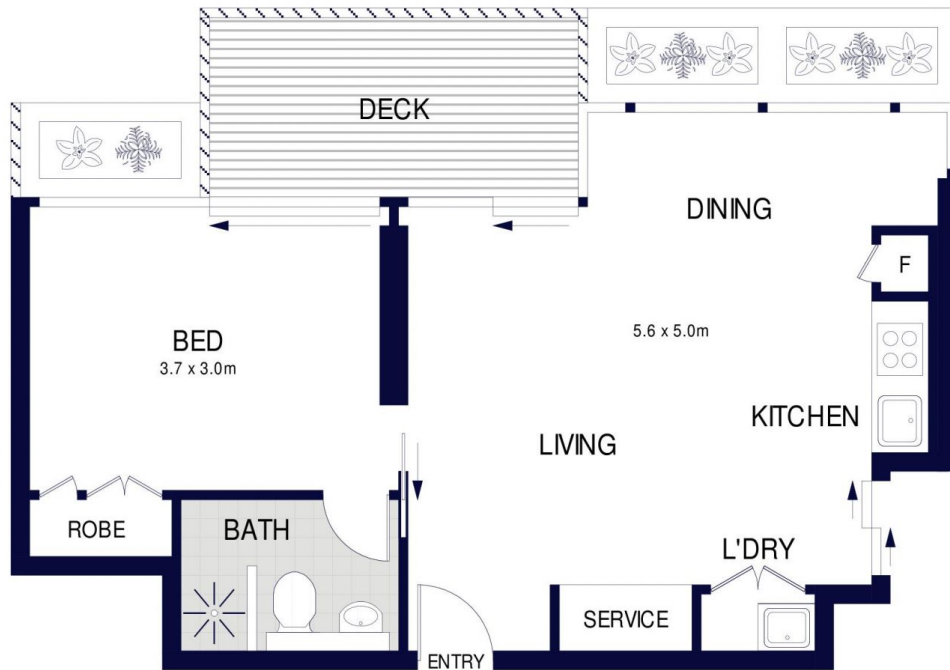

LEVEL TWENTY FOUR

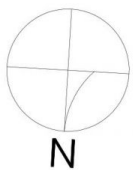

2411/3 CARLTON STREET, CHIPPENDALE



Scale in metres. Indicative only. Dimensions are approximate.

All information contained here in is gathered from sources we believe to be reliable.

However we cannot guarantee it's accuracy and interested persons should rely on their own enquiries.