



CITY LIVING



6/25A Hickson Road Walsh Bay NSW

2  **2**  **1** 

Architecturally designed to embrace the exceptional waterfront location and stunning views, this elegant Mirvac apartment presents an ideal opportunity for downsizers, investors or busy professionals. It's the ultimate peaceful and easy-care haven, located in the heart of a vibrant precinct.

KEY FEATURES

The location - Set on the third floor of the boutique Towns Place apartment complex, with sweeping views over the water towards Blues Point and beyond. The elevated northwest aspect enjoys stunning afternoon light.

The interiors - Freshly painted and carpeted throughout, the expansive open plan living areas flow seamlessly via bi-fold doors to a large, covered terrace. Along with

Price : \$ 2,800,000
Building Size : 134 sqm
View : <https://www.cityliving.com.au/sale/nsw/sydney-city/walsh-bay/residential/apartment/7734639>



Tasman Fallshaw
02 8248 9104

<https://www.cityliving.com.au>

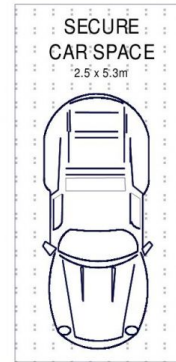

BASEMENT TWO

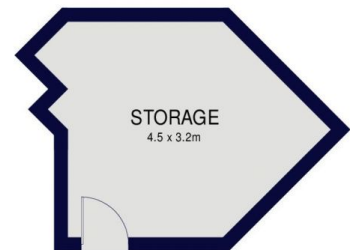

BASEMENT ONE

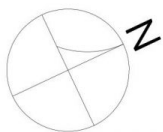

6/25A HICKSON ROAD, MILLERS POINT

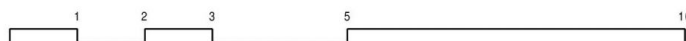

Scale in metres. Indicative only. Dimensions are approximate.

All information contained herein is gathered from sources we believe to be reliable.
However we cannot guarantee it's accuracy and interested persons should rely on their own enquiries.