



CITY LIVING



2702/187 Liverpool Street Sydney NSW

2  2  1 

Set high above Hyde Park in 'The Connaught', one of eastern Sydney's most highly regarded communities, this exceptional apartment offers a lifestyle opportunity like no other. With views that stretch uninterrupted across Hyde Park to St Marys, the Opera House and Harbour, this is inner city living at its finest.

KEY FEATURES

The layout - Opening to embrace the light of a prized due northern aspect, the home is designed with entertaining in mind with a large combined lounge and dining area that flows to a balcony and the view beyond. Both bedrooms are secluded at the rear of the home, ensuring peace and privacy in equal measure.

The facilities - Complete with a rooftop pool that offers a

Price : \$ 2,190,000
Building Size : 101 sqm
View : <https://www.cityliving.com.au/sale/nsw/sydney-city/sydney/residential/apartment/7767175>



Tasman Fallshaw
02 8248 9104



Anthony Kannis
02 8248 9109

<https://www.cityliving.com.au>

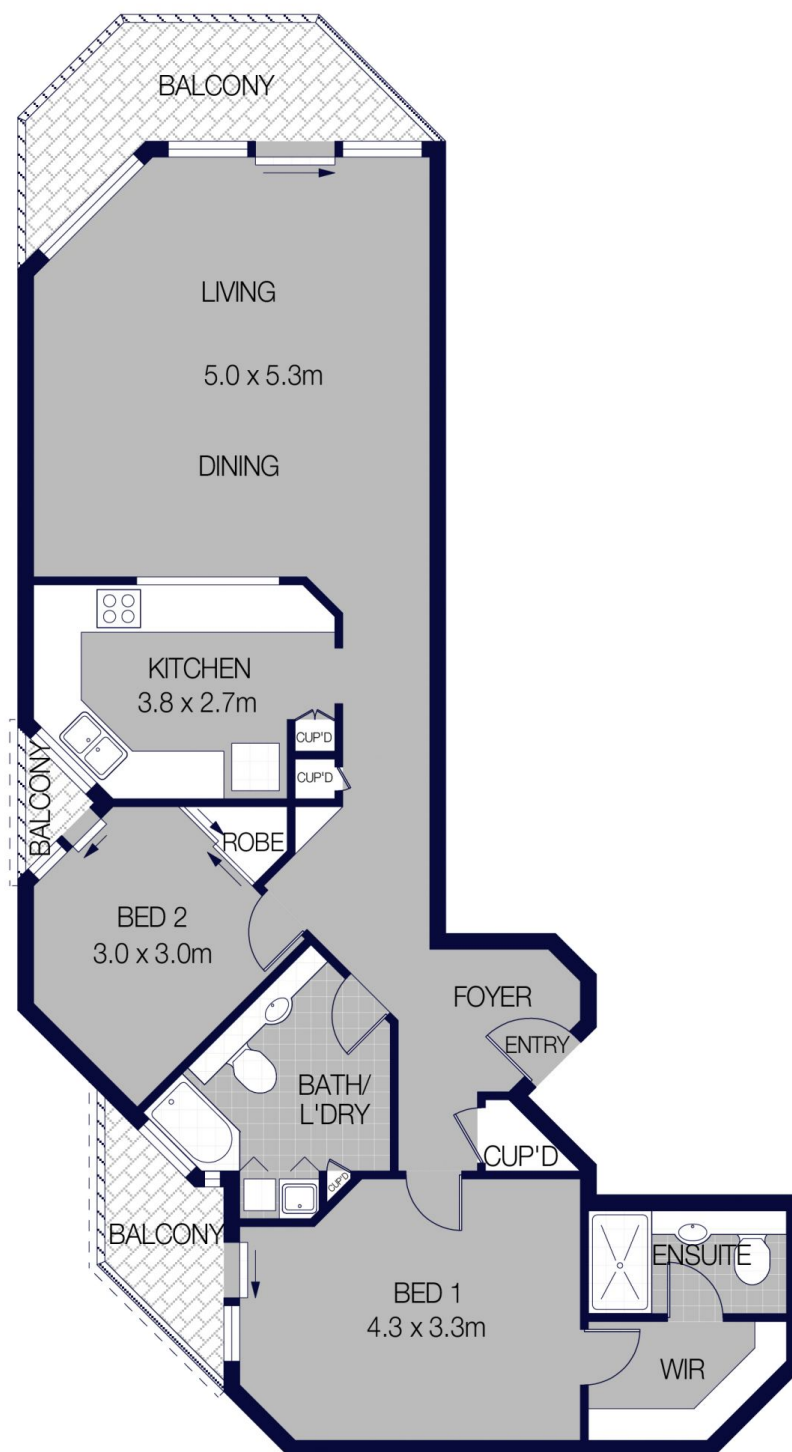
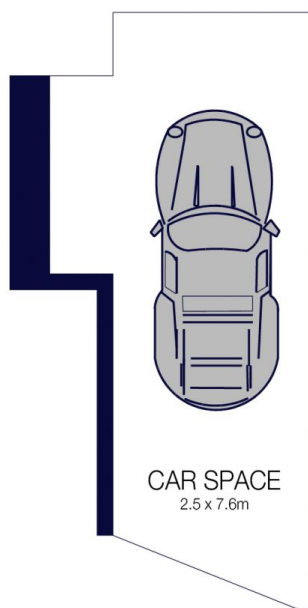

LEVEL TWENTY SEVEN

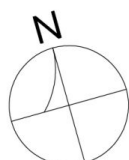

2702/187 LIVERPOOL STREET, SYDNEY

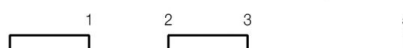

Scale in metres. Indicative only. Dimensions are approximate.
All information contained herein is gathered from sources we believe to be reliable.
However we cannot guarantee it's accuracy and interested persons should rely on their own enquiries.